



Mod. CG-A CG-A.1



COCCHI





Mod. CG-A

Tavolo Vaporizzante -Aspirante con Caldaia
Table Vaporissante - Aspirante avec Chaudière
Steaming - Vacuum Table with Boiler

CALDAIA - BOILER - CHAUDIERE

CONTROLLO ELETTRONICO A 2 SONDE
CONTROLE ELECTRONIQUE A 2 SONDES
ELECTRONIC CONTROL AT 2 PROBES

INOX 8 Lts



1250 x 250 x 450 mm

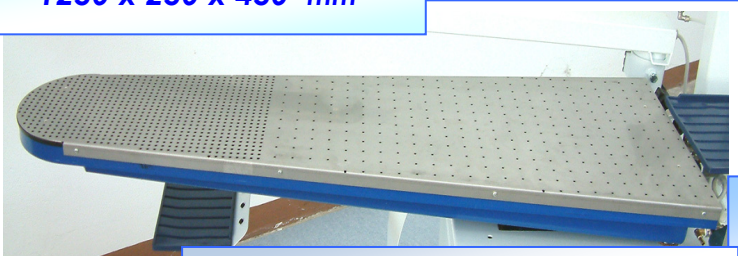

PIANO - CAMERA di VAPORE Lt 8
PLATEAU-CHAMBRE VAPEUR Lts 8
BOARD- STEAM TANK Lts 8

PIANO DI LAVORO IN ALLUMINIO
PLATEAU REPASSAGE EN ALUMINIUM
IRONING BOARD IN ALUMINIUM

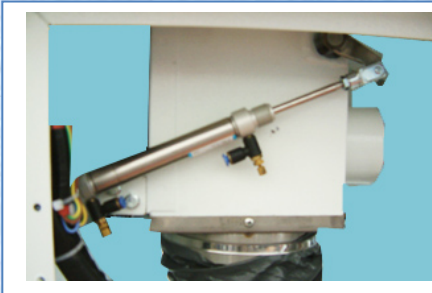

SCAMBIO PNEUMATICO ASPIRAZIONE PIANO >BRACCIOLLO
PNEUMATIC-EXCHANGE VACUUM BOARD > ARM
ECHANGE PNEUMATIQUE ASPIRATION PLATEAU>JEANNETTE



MOTORE ASPIRAZIONE
VACUUM MOTOR
MOTEUR ASPIRATION

Hp 1

Mod. CG-A 1

Tavolo Vaporizzante – Aspirante senza Caldaia
Table Vaporissante-Aspirante sans Chaudière
Steaming – Vacuum Table without Boiler

DATI TECNICI:	TECHNICAL DATA:	DONNE TECHNIQUE	
Motore Pompa Acqua Motore Aspirazione Caldaia Inox P.E.D 97/23 Valvola Sicurezza Certificata Resistenza Caldaia 8 Lt Resistenza Ferro Aria Compressa Richiesta Valvola Acqua con Filtro Elettrovalvole Vapore Cilindri Pneumatici	Water Pump Motor Vacuum Motor Inox Boiler P.E.D 97/23 Safety Valve Certified Boiler Elements 8 Lts Iron Elements Air Compresses needed Water-Valve with Filter Steam Solenoid Valves Pneumatic Pistons	Moteur Pompe Eau Moteur Aspiration Chaudière Inox P.E.D 97/23 Soupapae Securite Certifie Resistance Chaudière 8 Lts Resistance Fer Aire Comprimee Request. Vanne Eau avec Filtre Electrovannes Vapeur Pistons Pneumatiques	Hp 0,5 Hp 1 LT . 8 ½" Cat IV 6000 watt 1000 watt 7 Bar 3/8" Viton 180°C Viton / Inox

OPTIONALS:

2° Ferro
 Ferro Elettronico
 Ferro All-Steam
 Pistola Vapore
 Pistola Vapore-Aria
 Pistola Nebulizzatrice Acqua
 Braccio Maniche Aspirante/Soffiante/Riscaldato
 Braccio Inox smacchiatura
 Braccio Luce
 Braccio Luce con Sospensione Ferro
 Gruppo Smacchiatura (2 pistole Inox + 1 aria)
 Doppia Pedali (Destra – Sinistra)
 Poggiaferro Anteriore Mobile
 Caldaia Elettronica da **16 Lt INOX**
(res. 7,5-9-12 kW)

OPTIONALS:

2nd Iron
 Electronic Iron
 ALL-STEAM Iron
 Steam Gun
 Air-Steam Gun
 Atomizing (water) Gun
 Sleeve Arm (Vacuum-Blowinh-Heated)
 Spotting Inox Arm
 Light Arm
 Light Arm with Iron suspension –trolley
 Spotting Unit (2 spotting guns + 1 dryer gun)
 Arm-Rest Mobile Anterior
 Boiler Electronic (3 probes) of **16 Lts INOX**
(elements 7,5-9-12 kw)

OPTIONS:

2eme Fer
 Fer Electronic
 Fer Vapeur-Vapeur
 Pistolet Vapeur
 Pistolet Aire-Vapeur
 Pistolet nebulissatrice
 Jeannette manches (Aspiran.-Souffl.-Chauff.)
 Jeannette Detachage Inox
 Bras Eclairage
 Bras Eclairage avec Suspension Fer x Chariot
 Repose Fer mobile Anterior
 Chaudière Electronique de **16 Lts INOX**
(res. 7,5-9-12 kw)



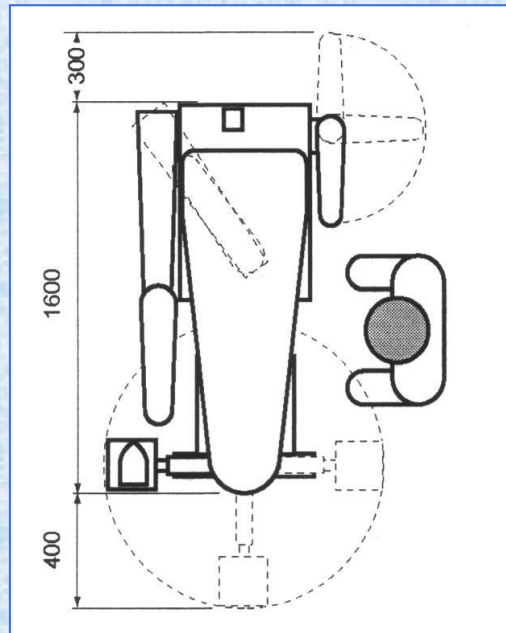
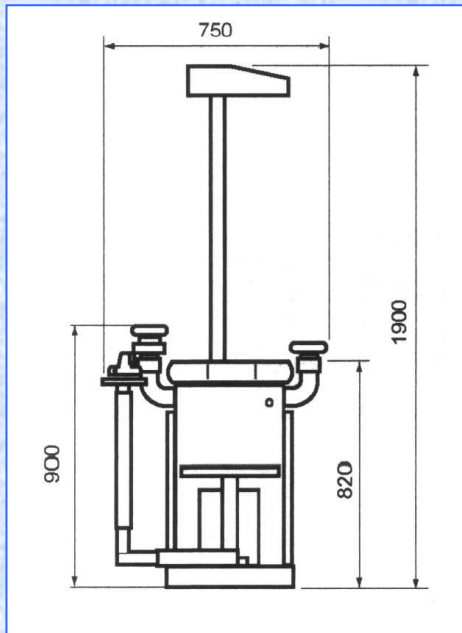

Tavolo concepito per raggiungere, con i suoi molteplici accessori di serie es optionali , il riconoscimento di "postazione completa di stiratura". Di ingombri ridotti, riesce a contenere non solo una caldaia "base " in Acciaio **INOX** da Lt 8 a controllo elettronico, ma anche su richiesta una piu' potente 16 Lt , sempre a controllo Elettronico con potenze da 7,5 a 12 Kw; per soddisfare le piu' svariate esigenze di produzione vapore. Grazie al suo innovativo sistema di utilizzo del vapore all'interno del piano vaporizzante, a parità di potenza Elettrica installata con un sistema tradizionale, otteniamo uno sfruttamento del vapore prodotto più alto del 20% con un conseguente risparmio di energia. I doppi pedali (su richiesta) ,l'appoggiaferro anteriore mobile permettono la stiratura da entrambi i lati della macchina, ed abbinandosi alla potente aspirazione, immediata e veloce vaporizzazione garantiscono una qualità e velocità tra le migliori del mercato.

Thanks to the wide range of standard and optional accessoires, this ironing table has been conceived in order to obtain a " fully equipped ironing station ". The compact size unit allow fitting a 8 Lts **INOX** Boiler and, on request, even a more powerfull 16.5 Lts boiler (with elemets from 7,5 to 12 Kw) that are both electronically controlled (2 probes), so as to meet the different steam requirements. The new system steam exploiting , inside the working surface/board require the same power as the one that is normally used for traditional system, but at the same it ensures 20% higher efficiency as far as steam generator is concerned together with significant reduction in power consumption. The double pedals (on request) and the mobile front iron-rest allow ironing from both sides of the machine, in addition to powerful suction , hi-speed steam exit , they ensure an ironing result that is unique in terms of quality of reducing time of execution and became the CG-A one the most complete machine now available on the market.

Table à repasser conçue pour être, grâce à ses multiples accessoires de série et optionnels, un « poste de repassage complet ». De dimensions réduites, elle comprend non seulement une chaudière de base de 8 Lts **INOX** à contrôle électronique mais aussi, sur demande, une chaudière plus puissante de 16,5 Lts toujours à contrôle électronique (2 sondes) , de puissance allant de 7,5 a 12 Kw , afin de satisfaire toutes les exigences de production de vapeur. Grace à son innovatif système d'utilisation de la vapeur situé à l'intérieur du plateau diffuseur, avec une puissance identique à celle installée sur un système traditionnel, nous obtenons un 20% de vapeur en plus tout en réalisant des économies d'énergie . les doubles pédales ainsi que le repose-fer antérieur permettent de repasser des deux cotès de la machine, et associés à l'aspiration puissant, à la vaporisation rapide immédiate, ils garantissent un repassage rapide et de qualité font situer le CG-A parmi les meilleures appareils presents sur le marché.

COCCHI srl

via Pacinotti 19/a – 40017 San Giovanni in Persiceto – Bologna – Italy
tel. (+39 051 821787) fax (+39 051 826935)

web site : www.cocchi.net

email : info@cocchi.net

